



UA30X1-12
UC30X1-11

0.3" SINGLE DIGIT DISPLAY
(GI TYPE)

Features

- * LOW CURRENT REQUIREMENTS
- * EXCELLENT CHARACTER APPERANCE
- * HIGH LIGHT OUTPUT
- * RELIABLE AND RUGGED
- * IC COMPATIBLE

Absolute Maximum Ratings at T_A=25°C

REVERSE VOLTAGE PER LED CHIP (<100µ A)	GaAsP RED 3.0V, OTHER 5.0V
D.C. FORWARD CURRENT PER LED CHIP.....	30 mA
PULSE CURRENT (1/10 DUTY CYCLE,0.1 ms PULSE WIDTH) PER LED CHIP.....	100 mA
OPERATING TEMPERATURE RANGE.....	-25°C TO +85°C
STORAGE TEMPERATURE RANGE.....	-25°C TO +100°C
LEAD SOLDERING TEMP. (1.6mm FROM SEATING PLANE).....	260°C FOR 3

Electrical/optical characteristics at T_A=25°C

PART NUMBER	LED CHIP	FACE COLOR	PEAK WAVELENGTH @20mA(nm)	FORWARD VOLTAGE @20mA(V)		LUMINOUS INTENSITY @10(mcd)				
				TYP.	MAX.	MIN.	TYP.			
UA3051-12 BWAK	UC3051-11 BWAK	GaP	RED	BLACK	WHITE	700	2.1	3.0	0.3	0.8
UA3021-12 EWAK	UC3021-11 EWAK	GaP	GREEN	GREY	WHITE	567	2.1	3.0	1.1	2.9
UA3031-12 EWAK	UC3031-11 EWAK	GaAsP ON GaP	YELLOW	GREY	WHITE	585	2.1	3.0	0.9	2.3
UA3041-12 EWAK	UC3041-11 EWAK	GaAsP ON GaP	ORANGE	GREY	WHITE	635	2.1	3.0	1.3	3.3
UA3041R-12 EWAK	UC3041R-11 EWAK	GaAsP ON GaP	HI-EFF.RED	RED	RED	635	2.1	3.0	1.3	3.3

Package Dimensions And Pin Function

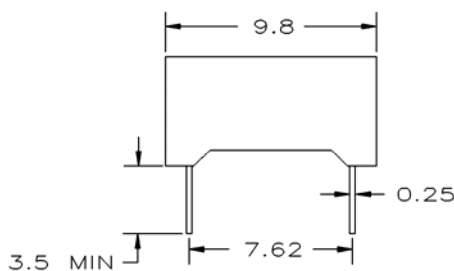
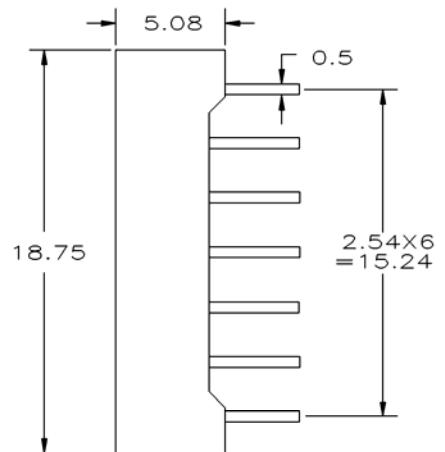
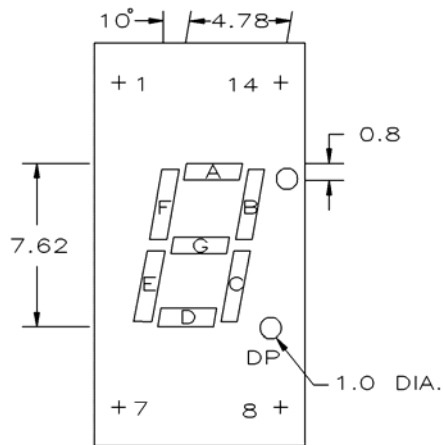

<p>UA30X1-12 COMMON ANODE</p> <p>PIN NO. FUNCTION</p> <p>1.CATHODE A</p> <p>2.CATHODE F</p> <p>3.COMMON ANODE</p> <p>4.NO PIN</p> <p>5.NO PIN</p> <p>6.CATHODE DP</p> <p>7.CATHODE E</p> <p>8.CATHODE D</p> <p>9.NO CONNECTION</p> <p>10.CATHODE C</p> <p>11.CATHODE G</p> <p>12.NO PIN</p> <p>13.CATHODE B</p> <p>14.COMMON ANODE</p>	<p>UC30X1-11 COMMON CATHODE</p> <p>PIN NO. FUNCTION</p> <p>1.ANODE F</p> <p>2.ANODE G</p> <p>3.NO PIN</p> <p>4.COMMON CATHODE</p> <p>5.NO PIN</p> <p>6.ANODE E</p> <p>7.ANODE D</p> <p>8.ANODE C</p> <p>9.ANODE DP</p> <p>10.NO PIN</p> <p>11.NO PIN</p> <p>12.COMMON CATHODE</p> <p>13.ANODE B</p> <p>14.ANODE A</p>
--	---

1.ALL DIMENSIONS ARE IN mm, TOLERANCE IS ±0.25mm UNLESS OTHERWISE NOTED.

2.THE SLOPE ANGLE OF ANY PIN MAY BE ±5.0°MAX.